

ME Metal Encased Wipers - Inch

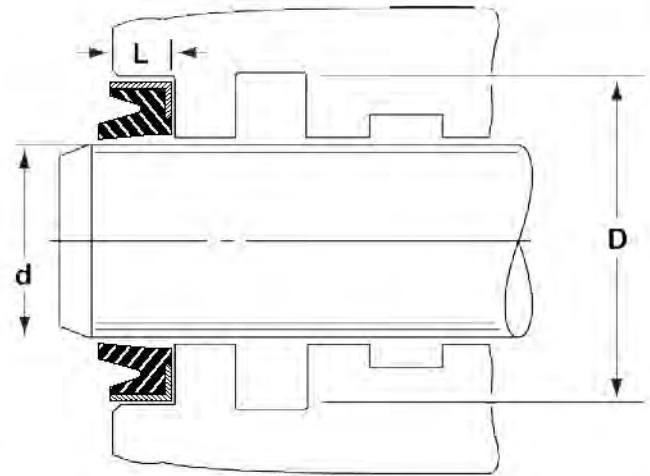

ALTERNATIVE SEALS:
504, ME Cat type



EXAMPLE: ME1250HJ-P				
Prefix	Inside Diameter	Cross Section	Height	Suffix
ME	1250	H	J	-P
	1-1/4"	1/4"	5/16"	MATERIAL (P=PU/N=NBR)

1ST LETTER IN SUFFIX DESIGNATES C/S. C=3/32, D=1/8, E=5/32, F=3/16, G=7/32, H=1/4, I=9/32, J=5/16, K=1/32, L=3/8, M=13/32, P=1/2, T=5/8

2ND LETTER IN SUFFIX DESIGNATES HT. C=3/32, D=1/8, E=5/32, F=3/16, G=7/32, H=1/4, I=9/32, J=5/16, K=11/32, L=3/8, M=13/32, P=1/2, T=5/8

Metal encased wipers are manufactured from a corrosion-resistant carbon steel case with either a urethane or nitrile lip chemically bonded to it. N = Nitrile P = Polyurethane

These wipers are designed with a slightly oversized diameter, thus ensuring a secure fit in the recess after installation.

Polyurethane temperature: -40° to 212°F

Nitrile temperature: -40° to 250°F

Part No.	Rod Diameter +.000 -.002 d	Groove Dimensions	
		+0.001 D	+0.015 -.000 L
ME0250DD-N	0.250	0.500	0.125
ME0312DD-N	0.312	0.562	0.125
ME0375DD-N	0.375	0.625	0.125
ME0375FH-N	0.375	0.750	0.250
ME0375HH-N	0.375	0.875	0.250
ME0437CD-N	0.437	0.625	0.125
ME0437FF-N	0.437	0.836	0.187
ME0500CC-N	0.500	0.687	0.093
ME0500DD-N	0.500	0.750	0.125
ME0500FD-N	0.500	0.875	0.125
ME0500FH-N	0.500	0.875	0.250
ME0562DD-N	0.562	0.812	0.125
ME0625CC-N	0.625	0.812	0.093
ME0625DD-N	0.625	0.875	0.125
ME0625EF-N	0.625	0.937	0.187
ME0625FD-N	0.625	1.000	0.125
ME0625GF-N	0.625	1.062	0.187
ME0625GH-N	0.625	1.062	0.250
ME0625HH-N	0.625	1.125	0.250
ME0625HJ-P	0.625	1.125	0.312
ME0625JH-N	0.625	1.250	0.250
ME0687DD-N	0.687	0.937	0.125

Part No.	Rod Diameter +.000 -.002 d	Groove Dimensions	
		+0.001 D	+0.015 -.000 L
ME0687EF-N	0.687	1.000	0.187
ME0687KD-N	0.687	1.375	0.125
ME0750DD-N	0.750	1.000	0.125
ME0750EF-N	0.750	1.062	0.187
ME0750FF-N	0.750	1.125	0.187
ME0750HH-N	0.750	1.250	0.250
ME0750HJ-P	0.750	1.250	0.312
ME0812MF-N	0.812	1.625	0.187
ME0875DD-N	0.875	1.125	0.125
ME0875EE-N	0.875	1.187	0.156
ME0875FF-N	0.875	1.250	0.187
ME0875GH-N	0.875	1.312	0.250
ME0875HJ-P	0.875	1.375	0.312
ME1000DD-N	1.000	1.250	0.125
ME1000ED-N	1.000	1.312	0.125
ME1000FF-N	1.000	1.375	0.187
ME1000GH-N	1.000	1.437	0.250
ME1000HF-N	1.000	1.500	0.187
ME1000HJ-P	1.000	1.500	0.312
ME1000JH-N	1.000	1.625	0.250
ME1062DD-N	1.062	1.312	0.125
ME1062FF-N	1.062	1.437	0.187

ME Metal Encased Wipers - Inch, cont'd.

Part No.	Rod Diameter +0.000 -0.002 d	Groove Dimensions	
		+0.001 D	+0.015 -0.000 L
ME1062GF-N	1.062	1.500	0.187
ME1125DD-N	1.125	1.375	0.125
ME1125FF-N	1.125	1.500	0.187
ME1125GH-N	1.125	1.562	0.250
ME1125HH-N	1.125	1.625	0.250
ME1125HJ-P	1.125	1.625	0.312
ME1125JH-N	1.125	1.750	0.250
ME1187FF-N	1.187	1.562	0.187
ME1187GH-N	1.187	1.625	0.250
ME1187GH-P	1.187	1.625	0.250
ME1219LK-N	1.219	1.979	0.343
ME1250DD-N	1.250	1.500	0.125
ME1250FH-N	1.250	1.625	0.250
ME1250GF-N	1.250	1.687	0.187
ME1250HH-N	1.250	1.750	0.250
ME1250HH-P	1.250	1.750	0.250
ME1250HJ-P	1.250	1.750	0.312
ME1250JH-N	1.250	1.875	0.250
ME1250LH-N	1.250	1.983	0.250
ME1250ML-P	1.250	2.062	0.375
ME1312DD-N	1.312	1.562	0.125
ME1312HH-N	1.312	1.812	0.250
ME1375DD-N	1.375	1.625	0.125
ME1375FF-N	1.375	1.750	0.187
ME1375HH-N	1.375	1.875	0.250
ME1375HJ-P	1.375	1.875	0.312
ME1375IH-N	1.375	1.937	0.250
ME1375JJ-N	1.375	2.000	0.312
ME1375OH-N	1.375	2.282	0.250
ME1437ID-N	1.437	2.000	0.125
ME1500DL-N	1.500	1.750	0.375
ME1500EF-N	1.500	1.812	0.187
ME1500FF-N	1.500	1.875	0.187
ME1500FF-P	1.500	1.875	0.187
ME1500FH-N	1.500	1.875	0.250
ME1500FH-P	1.500	1.875	0.250
ME1500HF-N-1	1.500	1.983	0.187
ME1500HH-N	1.500	2.000	0.250
ME1500HH-P	1.500	2.000	0.250
ME1500HJ-N	1.500	2.000	0.312
ME1500HJ-P	1.500	2.000	0.312
ME1500IH-N	1.500	2.062	0.250
ME1500JJ-P	1.500	2.125	0.312
ME1500LH-N	1.500	2.250	0.250
ME1500LL-P	1.500	2.250	0.375

Part No.	Rod Diameter +0.000 -0.002 d	Groove Dimensions	
		+0.001 D	+0.015 -0.000 L
ME1500MK-N	1.500	2.327	0.343
ME1500OH-N	1.500	2.437	0.250
ME1500PH-N	1.500	2.500	0.250
ME1500RH-N	1.500	2.625	0.250
ME1562OH-N	1.562	2.500	0.250
ME1562RL-N	1.562	2.688	0.375
ME1625DD-N	1.625	1.875	0.125
ME1625FF-N	1.625	2.000	0.187
ME1625HH-N	1.625	2.125	0.250
ME1625HJ-P	1.625	2.125	0.312
ME1687JP-N	1.687	2.328	0.500
ME1687MI-N	1.687	2.500	0.281
ME1750FF-N	1.750	2.125	0.187
ME1750HF-N	1.750	2.250	0.187
ME1750HH-N	1.750	2.250	0.250
ME1750HH-P	1.750	2.250	0.250
ME1750HJ-P	1.750	2.250	0.312
ME1750JH-N	1.750	2.375	0.250
ME1750KL-P	1.750	2.437	0.375
ME1750LL-P	1.750	2.500	0.375
ME1750MH-N	1.750	2.562	0.250
ME1750NH-N	1.750	2.625	0.250
ME1812LN-N	1.812	2.562	0.437
ME1875FF-N	1.875	2.250	0.187
ME1875HJ-P	1.875	2.375	0.312
ME1875JH-N	1.875	2.500	0.250
ME1875KL-P	1.875	2.563	0.375
ME1875RH-N	1.875	3.000	0.250
ME1875RP-N	1.875	3.000	0.500
ME1937II-N	1.937	2.506	0.281
ME2000FF-N	2.000	2.375	0.187
ME2000FH-N	2.000	2.375	0.250
ME2000HH-N	2.000	2.500	0.250
ME2000HH-P	2.000	2.500	0.250
ME2000HJ-P	2.000	2.500	0.312
ME2000JH-N	2.000	2.625	0.250
ME2000JJ-N	2.000	2.625	0.312
ME2000KH-N	2.000	2.687	0.250
ME2000KL-P	2.000	2.687	0.375
ME2000LL-P	2.000	2.750	0.375
ME2062OJ-N	2.062	3.000	0.312
ME2125FF-N	2.125	2.500	0.187
ME2125HH-P	2.125	2.625	0.250
ME2125HJ-P	2.125	2.625	0.312
ME2125LH-N	2.125	2.875	0.250

ME Metal Encased Wipers - Inch, cont'd.

Part No.	Rod Diameter +.000 -.002 d	Groove Dimensions	
		+ .001 D	+ .015 -.000 L
ME2125LL-P	2.125	2.875	0.375
ME2125TL-N	2.125	3.372	0.375
ME2250FF-N	2.250	2.625	0.187
ME2250FH-N	2.250	2.625	0.250
ME2250HH-N	2.250	2.750	0.250
ME2250HH-P	2.250	2.750	0.250
ME2250HJ-P	2.250	2.750	0.312
ME2250JH-N	2.250	2.875	0.250
ME2250LH-N	2.250	2.996	0.250
ME2250LL-P	2.250	3.000	0.375
ME2250RL-N	2.250	3.375	0.375
ME2250SH-N	2.250	3.442	0.250
ME2312KH-N	2.312	3.000	0.250
ME2312KL-N	2.312	3.000	0.375
ME2375HJ-P	2.375	2.875	0.312
ME2375LL-P	2.375	3.125	0.375
ME2500HF-P	2.500	3.000	0.187
ME2500HH-N	2.500	3.000	0.250
ME2500HH-P	2.500	3.000	0.250
ME2500HJ-P	2.500	3.000	0.312
ME2500JH-N	2.500	3.125	0.250
ME2500LL-P	2.500	3.250	0.375
ME2500PH-N	2.500	3.500	0.250
ME2500PL-P	2.500	3.500	0.375
ME2625HH-P	2.625	3.125	0.250
ME2660IL-N	2.660	3.250	0.375
ME2750FF-N	2.750	3.125	0.187
ME2750HH-N	2.750	3.250	0.250
ME2750HJ-P	2.750	3.250	0.312
ME2750LL-P	2.750	3.500	0.375
ME2750PL-N	2.750	3.750	0.375
ME2750PP-P	2.750	3.750	0.500
ME2875HH-N	2.875	3.371	0.250
ME2875JH-P	2.875	3.500	0.250
ME3000HH-N	3.000	3.500	0.250
ME3000HJ-P	3.000	3.500	0.312
ME3000LH-N	3.000	3.750	0.250
ME3000LH-P	3.000	3.750	0.250
ME3000LL-P	3.000	3.750	0.375
ME3000PP-P	3.000	4.000	0.500
ME3125HF-P	3.125	3.625	0.187
ME3125JL-P	3.125	3.750	0.375
ME3250HJ-P	3.250	3.750	0.312
ME3250JJ-N	3.250	3.875	0.312
ME3250JJ-P	3.250	3.875	0.312

Part No.	Rod Diameter +.000 -.002 d	Groove Dimensions	
		+ .001 D	+ .015 -.000 L
ME3250PP-P	3.250	4.250	0.500
ME3375FL-P	3.375	3.750	0.375
ME3375JJ-P	3.375	4.000	0.312
ME3500FF-N	3.500	3.875	0.187
ME3500HH-N	3.500	4.000	0.250
ME3500HJ-P	3.500	4.000	0.312
ME3500JJ-P	3.500	4.125	0.312
ME3500LJ-P	3.500	4.250	0.312
ME3500PP-P	3.500	4.500	0.500
ME3750JH-N	3.750	4.375	0.250
ME3750JJ-P	3.750	4.375	0.312
ME3750PP-P	3.750	4.750	0.500
ME4000HJ-P	4.000	4.500	0.312
ME4000JJ-P	4.000	4.625	0.312
ME4000LJ-P	4.000	4.750	0.312
ME4000NH-N	4.000	4.875	0.250
ME4000PP-P	4.000	5.000	0.500
ME4250HJ-P	4.250	4.750	0.312
ME4250JJ-P	4.250	4.875	0.312
ME4250PP-P	4.250	5.250	0.500
ME4375JJ-P	4.375	5.000	0.312
ME4500JJ-P	4.500	5.125	0.312
ME4500LJ-P	4.500	5.250	0.312
ME4500PP-P	4.500	5.500	0.500
ME4750JJ-P	4.750	5.375	0.312
ME4750PP-P	4.750	5.750	0.500
ME5000JJ-P	5.000	5.625	0.312
ME5000LJ-P	5.000	5.750	0.312
ME5000PP-P	5.000	6.000	0.500
ME5500JL-P	5.500	6.125	0.375
ME5500LJ-P	5.500	6.250	0.312
ME5750PP-P	5.750	6.750	0.500
ME6000JL-P	6.000	6.625	0.375
ME6000LL-P	6.000	6.750	0.375
ME6000PP-P	6.000	7.000	0.500
ME6500LJ-P	6.500	7.250	0.312
ME6500PT-P	6.500	7.500	0.625
ME6750HJ-P	6.750	7.250	0.312
ME7000LJ-P	7.000	7.750	0.312
ME7000PP-P	7.000	8.000	0.500
ME7000RT-P	7.000	8.125	0.625
ME7250LJ-P	7.250	8.000	0.312
ME8125HJ-P	8.125	8.625	0.312
ME9000LR-P	9.000	9.750	0.550